



**Building**  
a Brand New  
**Future**

## about us

Since 1990, Prefab Technology Pte Ltd has been at the forefront of precast components development, resulting in a full range of precast concrete components that have improved ease of construction and quality of buildings for our clients. Our vision is to be one of the top integrated building groups in the region, leveraging on prefabrication technology and operational excellence, and to provide high value added services to our customers.

Our constant strive towards quality excellence and innovation has put us among the market leaders in our field. But it is our unique philosophy that makes us clearly stand out from the rest. It is our goal to always do more, to do better and to bring our clients a valuable plus.

The progressive management of our products, the high standard of our services and our commitment to our clients help us excel in every project we undertake. At all times we produce high quality products, and provide on time delivery and pro-active customer service. This is more than a philosophy; it is evident in every aspect of our business.

“We commit ourselves to continuous improvements in our quality and provide on time delivery and pro-active customer service.”

## introduction to prefab

It is our truly makes We employ a n d a s s i s t in selecting materials as a d v i s i n g team that a difference. architects engineers to developers architectural well as them on technical and other issues. Our production team ensures the accuracy and completeness of structural drawings, handles quality control inspection, and plans schedules and production in accordance with client requirements. Our sales department coordinates the project so that deadlines are met. It also functions as a communication channel between all departments, and well as a channel for client feedback.

We commit ourselves to continuous improvements in our quality and cost-effectiveness through employee re-training and effective utilization of resources. This gives us the insight and expertise to resolve installation and maintenance problems effectively and speedily.

More and more architects, engineers, contractors and developers are embracing the flexibility, durability and safer building process afforded by the use of precast components. Furthermore, precast concrete construction is environmentally friendly with less timber used, cleaner worksites and a lower noise level of construction.

Prefab Technologies has been awarded with prestigious awards as  
PSB - ISO 9001:2000  
BVQI - ISO 9002  
Graded - L6 unlimited



## exterior products

Precast components are ideal for those parts of the building that are repetitive but difficult, time consuming and/or labor intensive to cast on site. They open up new possibilities in creating designs and improves the ease of construction and quality of buildings. They will enable contractors to save time and intensive labour.

Precast components allow architects much greater freedom in exercising their creativity, where certain shapes and expressions are impossible or difficult to construct without precasting. It allows architects to utilize various surface treatments, such as natural granite, exposed aggregates and patterned colour tiles.



### GABLE END WALL

The precast gable end wall is designed to integrate with and be supported by the adjacent beams and columns.



### PRECAST FACADE

The precast façade is designed as a non-critical panel and it allows architects much greater freedom in exercising their creativity, where certain shapes and expressions are difficult or no possibility to construct without precasting.

### BLDG PARAPET

In adapting precast parapet in the construction, it can be obviously seen or analyze that you can save more in terms of labour cost, "time and convenience to work rather than choosing cast-in-situ". Other than that, precast parapets can come on varieties of surface finishes similar to facades and besides you can design it in different artistic profile or shapes.



### SERVICE DUCTS

This precast ducts not only serve as a barrier or cover-up to all conduits services but it contribute to the architectural aspects and it can also be done on different finishes. It can be viewed as a false column of the structure thus implicating a stable and durable structure we have.



### PRECAST RIBBED WALL

Also called form liners finish achieved by using rubber material as a liner in the casting form to impart a particular finish to the face of the panel. Unlimited effects or textures can be achieved by use of liners and they are extremely versatile.



(FOR ST MICROELECTRONICS, PHASE I AT SERANGOON NORTH AVE 5)



**BUKIT PANJANG**  
NEIGHBOURHOOD 4 CONTRACT 11  
(Horkew Design & Build Project)



### PRECAST CURVED BEAM

Non-structural precast products designed as trellis on roof water tanks or any structure below, which will contribute much to the architectural features of the building. It can come in various types of finishes, shapes and length. These precast panels are located wherein you will notice it clearly upon looking on the whole building.

“Precast components allow architects much greater freedom in exercising their creativity, where certain shapes and expressions are impossible or difficult to construct without precasting”

“The Precast products work simultaneously at the factory and site to speed up construction time which results in great savings for the project owner in terms of project financing costs”

## interior products

6

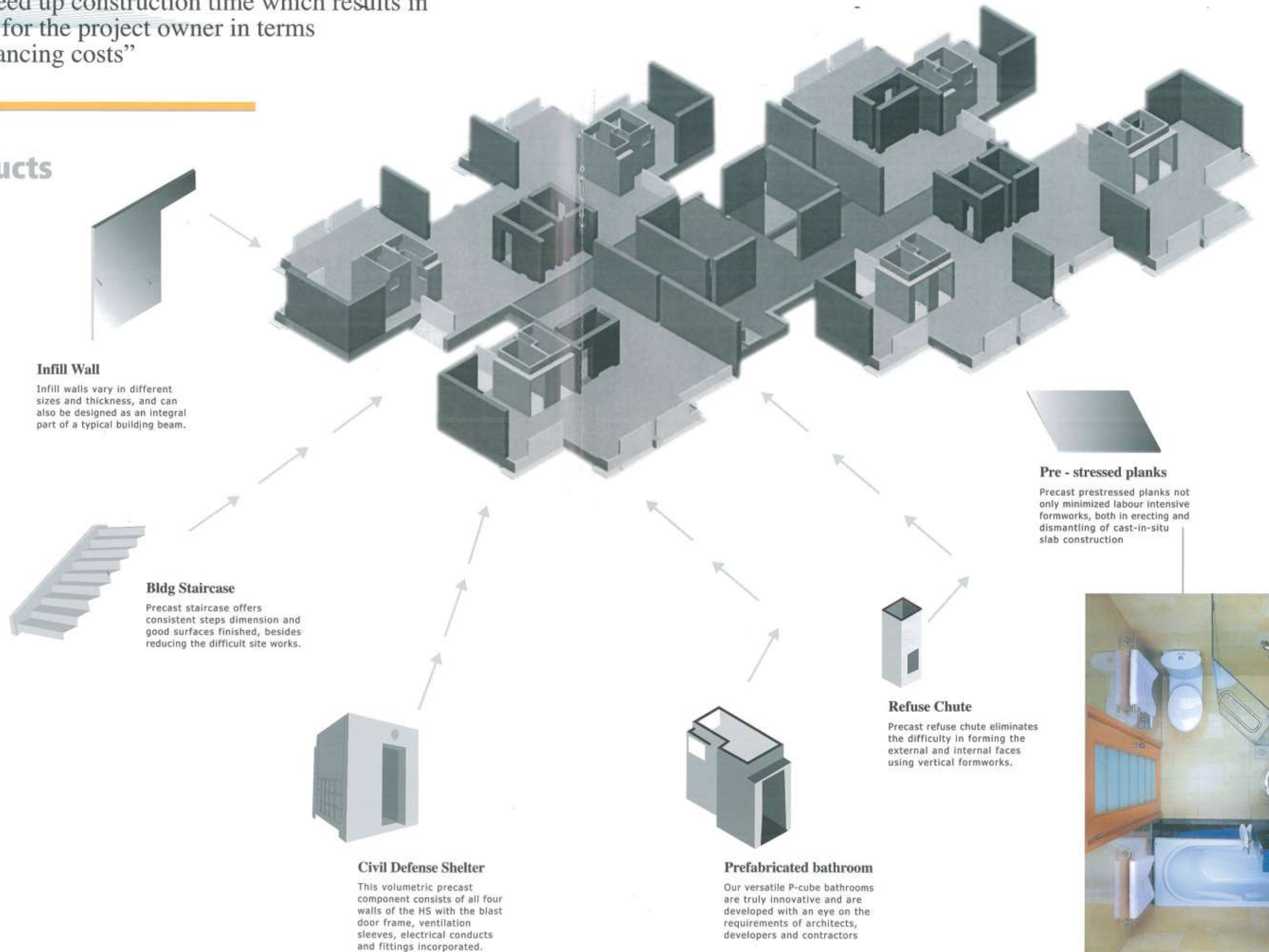

### Infill Wall

Infill walls vary in different sizes and thickness, and can also be designed as an integral part of a typical building beam.



### Bldg Staircase

Precast staircase offers consistent steps dimension and good surfaces finished, besides reducing the difficult site works.



### Civil Defense Shelter

This volumetric precast component consists of all four walls of the HS with the blast door frame, ventilation sleeves, electrical conducts and fittings incorporated.



### Refuse Chute

Precast refuse chute eliminates the difficulty in forming the external and internal faces using vertical formworks.



### Pre - stressed planks

Precast prestressed planks not only minimized labour intensive formworks, both in erecting and dismantling of cast-in-situ slab construction

### Prefabricated bathroom

Our versatile P-cube bathrooms are truly innovative and are developed with an eye on the requirements of architects, developers and contractors



Prefabricated bathroom

“The Precast products work simultaneously at the factory and site to speed up construction time which results in great savings for the project owner in terms of project financing costs”

## interior products

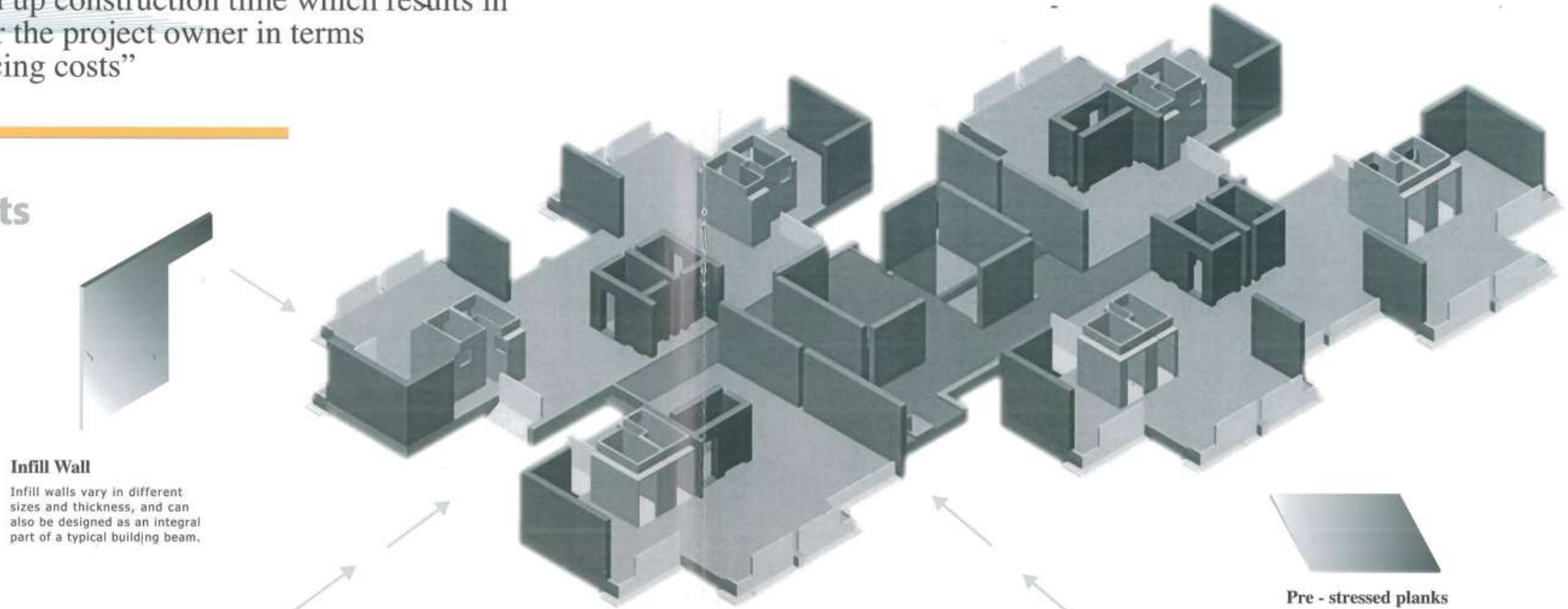

### Infill Wall

Infill walls vary in different sizes and thickness, and can also be designed as an integral part of a typical building beam.



### Bldg Staircase

Precast staircase offers consistent steps dimension and good surfaces finished, besides reducing the difficult site works.



### Civil Defense Shelter

This volumetric precast component consists of all four walls of the HS with the blast door frame, ventilation sleeves, electrical conduits and fittings incorporated.



### Refuse Chute

Precast refuse chute eliminates the difficulty in forming the external and internal faces using vertical formworks.



### Pre - stressed planks

Precast prestressed planks not only minimized labour intensive formworks, both in erecting and dismantling of cast-in-situ slab construction



### Prefabricated bathroom

Our versatile P-cube bathrooms are truly innovative and are developed with an eye on the requirements of architects, developers and contractors

Prefabricated bathroom

# list of products

No.	Types	Location
<b>A. Structural</b>		
1	Pre-stressed Planks	Interior
2	Non-prestressed Planks	Interior
3	Roof Water Tanks	Interior
4	Residential Suction Tanks	Interior
5	Hosereel Tanks	Interior
6	Civil Defense Shelter	Interior
7	Building Staircase	Interior
8	Precast Column 1/2/3 tiers	Interior/Exterior
9	Precast Beams	Interior/Exterior
10	Pilecap Forms	Interior
11	Space Adding Items - For Upgrading Projects	
	a. Precast Balcony	Exterior
	b. Living Room	Exterior
	c. Utility Room	Exterior
	d. Kitchen With Toilet	Exterior
	e. Bedroom	Exterior
	f. Lift Well	Exterior
12	Carpark Parapet	Exterior
13	Beam With Stump	Exterior
14	Aircon Ledge	Exterior
15	Gate Post	Exterior
16	Carpark Beam	Interior/Exterior
<b>B. Architectural</b>		
1	Precast Facades	Exterior
2	Building Parapets	Exterior
3	Service Ducts	Exterior
4	Column Claddings	Exterior
5	Beam Claddings	Exterior
6	Precast Walls (colored finish)	Exterior
7	Precast Ribbed Wall	Exterior
8	Roof Fascia	Exterior
9	Sunbreakers	Exterior
10	Screen Wall (colored finish)	Exterior
11	Gable End Wall (colored finish)	Exterior
12	Curved Beam - Roof	Exterior
<b>C. Non-Structural</b>		
1	Refuse Chute	Interior
2	Prefabricated Toilet/Bathroom	Interior
3	Partition Wall	Interior
4	U-Drain	Exterior



**Prefab Technology Private Limited**

